

SOUNDPROOFING DIRECT FIX TILES



REGUPOL SONUS MULTI 4.5

Suitable for green buildings, **REGUPOL sonus multi 4.5** is a sustainable product made from pre-consumer polyurethane foam and cork elastomer bound with polyurethane.

This environmentally preferable product has been independently certified as meeting the requirements of Good Environmental Choice Australia GECA 25-2011 v2.0i - Floor Coverings Standard. See www.geca.eco

REGUPOL sonus multi 4.5 is an acoustic underlay developed for its unique material composition which allows it to be a compatible surface to bond approved floor coverings such as carpet tiles, ceramic tiles, stone, marble, laminate, engineered timber and more.

All applications should be checked for suitability with the selected floor finish, waterproof membranes, **REGUPOL** adhesives, tile adhesives, grouts etc.



Available in:

Rolls	1m x 20lm
Modular Tiles	1050mm x 500mm
Thickness	4.5mm



ACOUSTICAL PERFORMANCE

DIRECT TILE Normalized Impact Sound Pressure Levels

Tested at CSIRO Hightett, in accordance with ISO 140-8: 1997 (E), ISO 140-6, AS ISO 717.2-2004, ASTM E989-89. Test area 11.7m². Results can vary when different floors are installed and/or if bonded

REPORT RG019

Layer of 10mm Porcelain Tile, bonded to **REGUPOL sonus multi 4.5mm**, bonded to 150mm Concrete Slab (no ceiling).

$L_{n,w}$ 61dB	ΔL_w 17dB	49 IIC
-------------------	----------------------	-----------

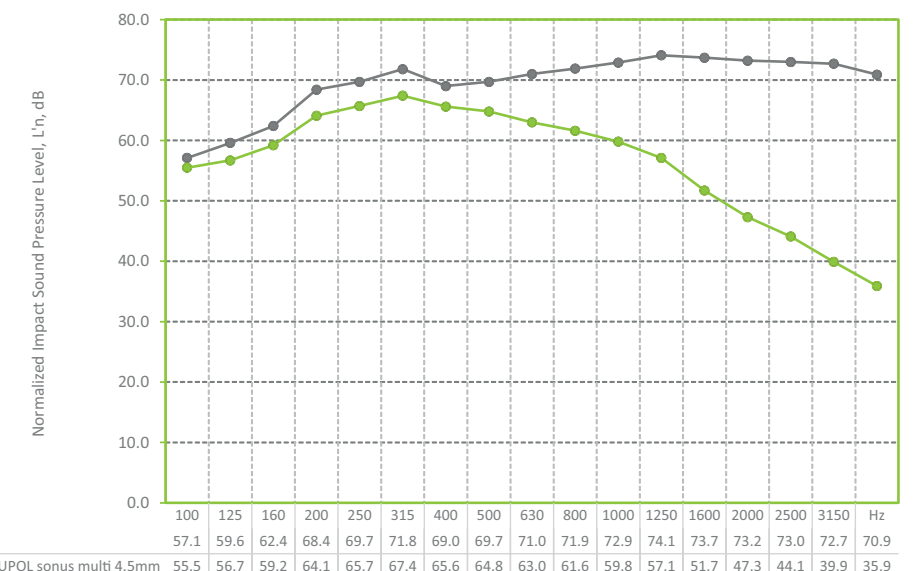

ANH NGOC THANH TRADING COMPANY LIMITED (ANTRADE CO., LTD.)

HCM office: R. 5.03, 5th Fl., Phuong Tower,
31C Ly Tu Trong Str., Ben Nghe W., Dist.1, HCMC.

Tel: (+84) 28 38257622 / 28 38257623

Website: www.antrade.vn || Hotline: +84 93 366 2138 || Email: sales@antrade.vn

HN office: R. 701, 7th Fl., 131 Bui Thi Xuan Str.,
Hai Ba Trung District, Ha Noi City, Vietnam.

Tel: (+84) 24 63289487 / 24 39749263

DRY AREA TILED FLOOR

This **REGUPOL sonus multi 4.5** system reflects a typical residential application with approved tiled floor coverings. For all other applications please contact **REGUPOL** acoustic division. Please note that drawings are not to scale and are for illustration purposes only.

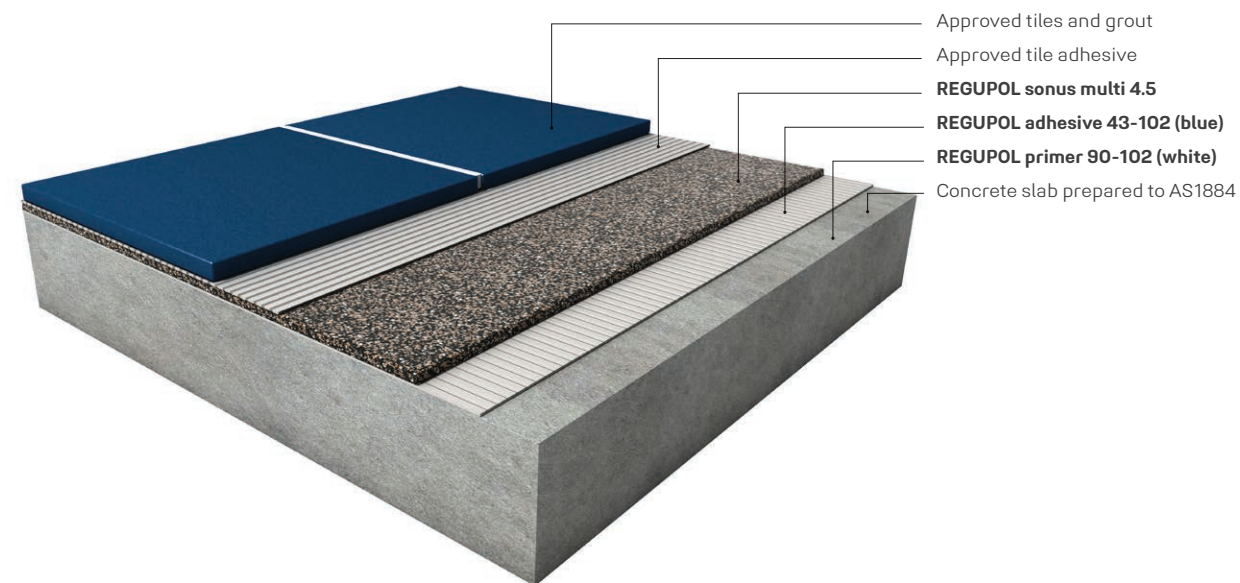

WET AREA TILED FLOOR

This **REGUPOL sonus multi 4.5** system reflects a typical residential application with approved tiled floor coverings. For all other applications please contact **REGUPOL** acoustic division. Please note that drawings are not to scale and are for illustration purposes only.

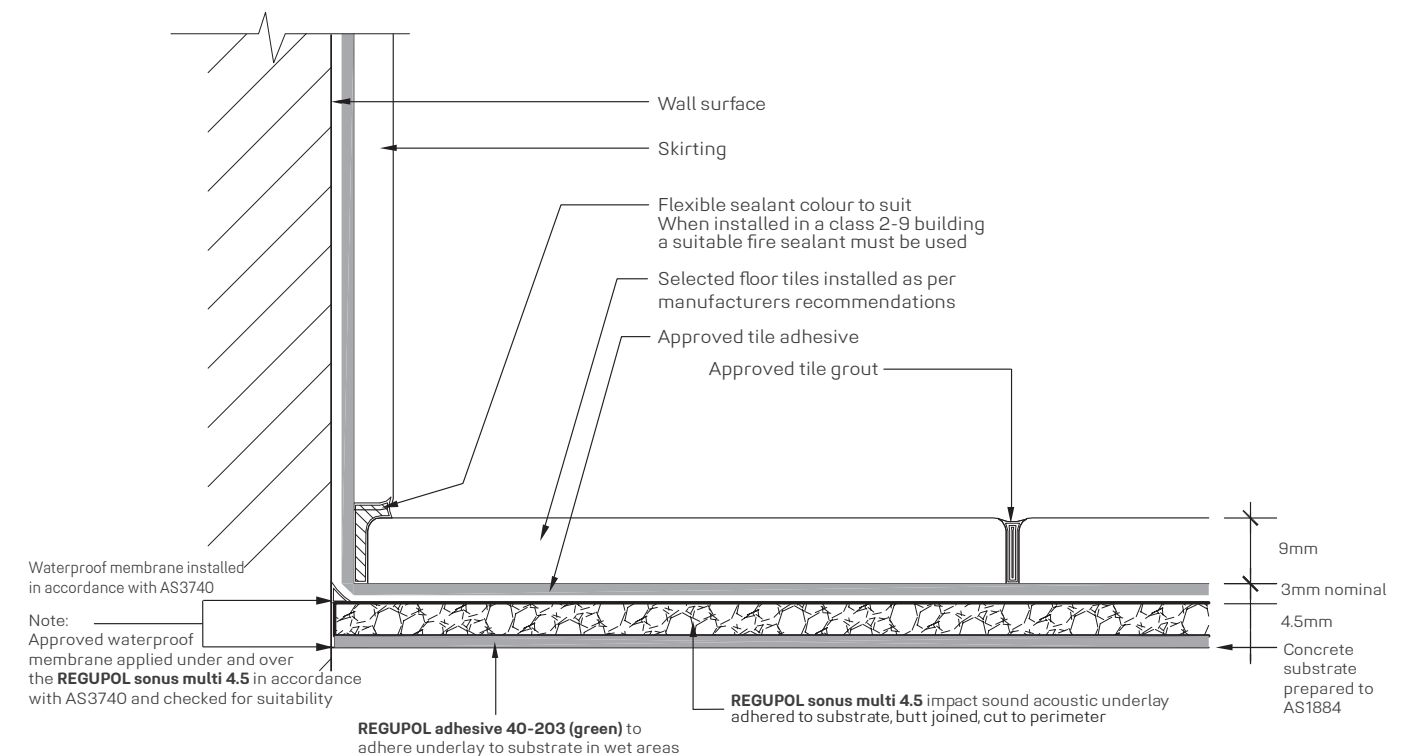
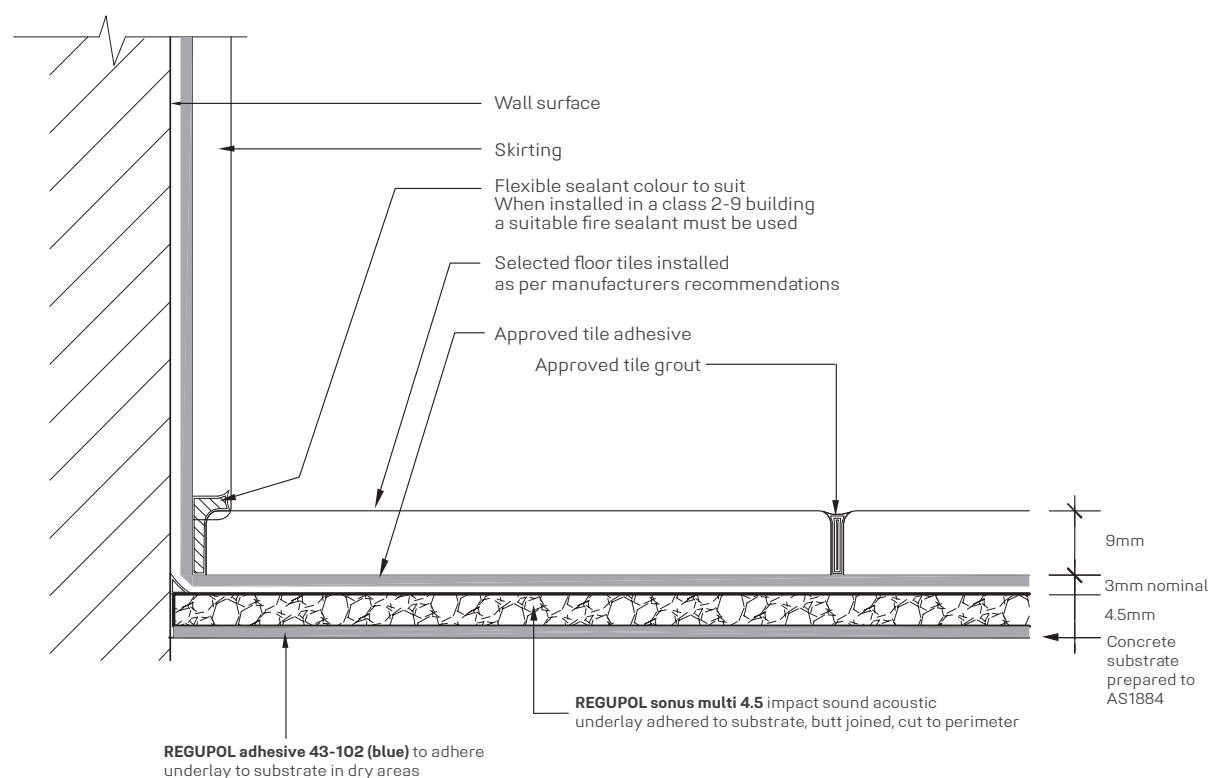
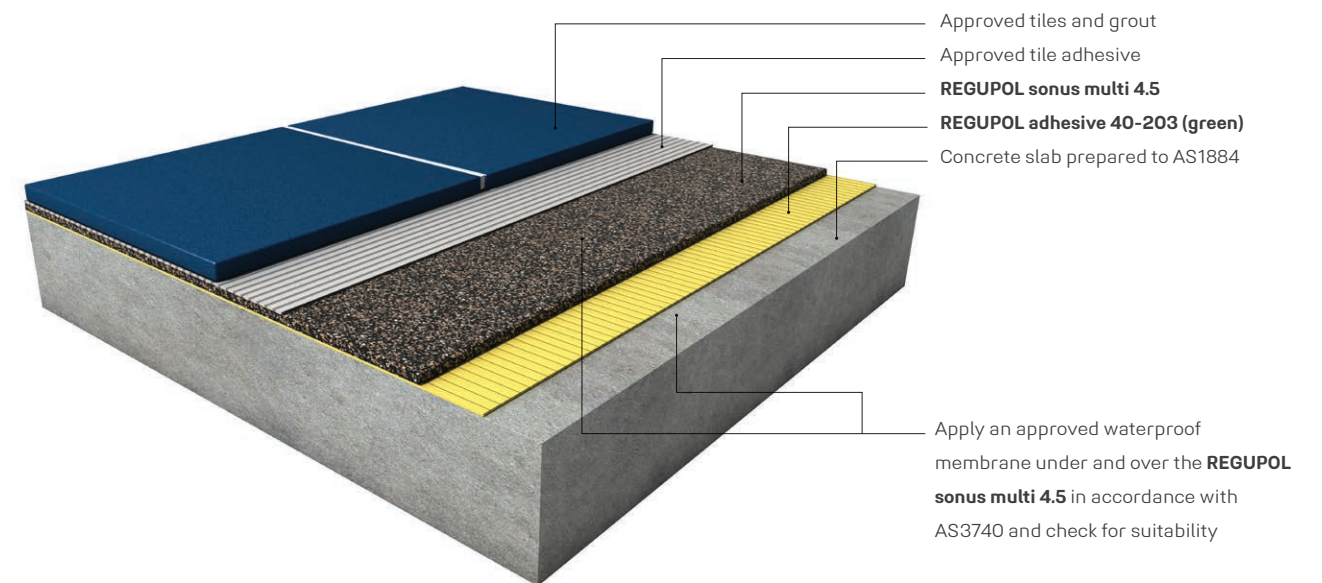

SOUNDPROOFING SCREEDED TILE FLOORS



REGUPOL SONUS MULTI 4.5

Suitable for green buildings, **REGUPOL sonus multi 4.5** is a sustainable product made from pre-consumer polyurethane foam and cork elastomer bound with polyurethane.

This environmentally preferable product has been independently certified as meeting the requirements of Good Environmental Choice Australia GECA 25-2011 v2.0i - Floor Coverings Standard. See www.geca.eco

REGUPOL sonus multi 4.5 is an acoustic underlay developed for its unique material composition which allows it to be a compatible surface to bond approved floor coverings such as carpet tiles, ceramic tiles, stone, marble, laminate, engineered timber and more.

All applications should be checked for suitability with the selected floor finish, waterproof membranes, **REGUPOL** adhesives, tile adhesives, grouts etc.



Available in:

Rolls	1m x 20lm
Modular Tiles	1050mm x 500mm
Thickness	4.5mm



ACOUSTICAL PERFORMANCE

TILE WITH SCREED Normalized Impact Sound Pressure Levels

Tested at CSIRO Hightett, in accordance with ISO 140-8: 1997 (E), ISO 140-6, AS ISO 717.2-2004, ASTM E989-89. Test area 10.8m². Results can vary when different floors are installed and/or if bonded.

REPORT RG094

Layer of 8mm Ceramic Tile bonded to 30mm Screed Bed, to **REGUPOL sonus multi 4.5mm**, to 150mm Concrete Slab (no ceiling).

$L_{n,w}$ 60dB	ΔL_w 19dB	50 IIC
-------------------	----------------------	-----------

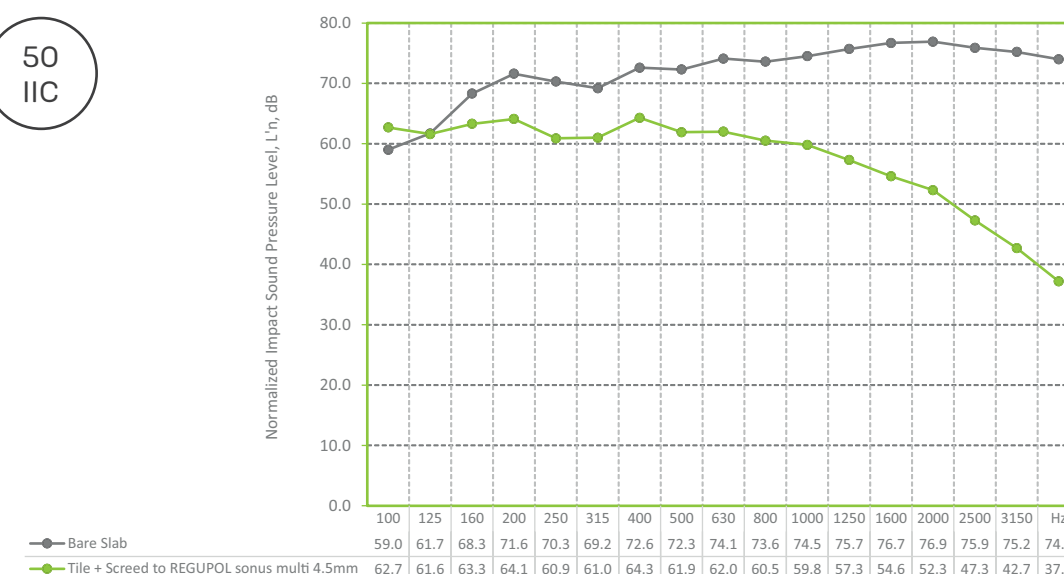

DRY AREA BONDED SCREED & TILE

This **REGUPOL sonus multi 4.5** system reflects a typical residential application with approved screed beds. For all other applications please contact **REGUPOL** acoustic division. Please note that drawings are not to scale and are for illustration purposes only.

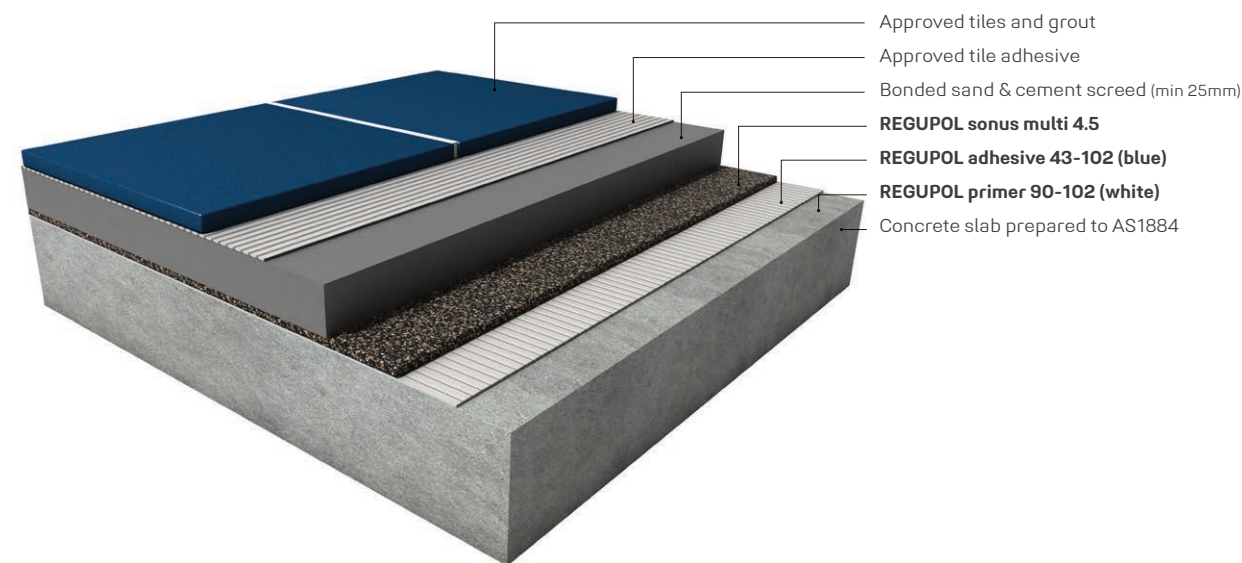

WET AREA BONDED SCREED & TILE

This **REGUPOL sonus multi 4.5** system reflects a typical residential application with approved screed beds. For all other applications please contact **REGUPOL** acoustic division. Please note that drawings are not to scale and are for illustration purposes only.

