

THE FLOORING SOLUTION FOR YOUR
FITNESS FACILITIES
FREE WEIGHTS TRAINING



 **REGUPOL**



OUR FLOOR FOR FREE WEIGHT TRAINING & WEIGHT LIFTING

Robust and protective:

REGUPOL puts your customers on the best footing: Our fitness floors are slip-resistant and comfortable – a safe and secure base for training with dumbbells and free weights.

However, our floor doesn't only support the athletes but protects the sub-base as well because, in free weight training or weight lifting, floor structures need to withstand hefty impacts. Our **REGUPOL** everroll fitness floors are incredibly resilient and impact resistant.

Do you have acoustic challenges to deal with? When it comes to impact sound, we'll be happy to develop the right acoustic solution on a project-specific basis.

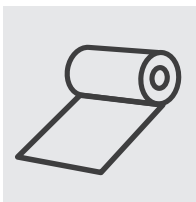

Rolls

Resilient | protect the sub-base | extremely slip resistant | standard thicknesses: 8 to 12 mm

Our products: REGUPOL everroll classic, REGUPOL everroll ultimate

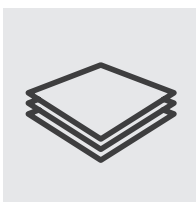

Multi-Layer System Build-Up

Individual selection of protective function and comfort levels | project-specific solutions for acoustic requirements

Our products: REGUPOL everroll impact, REGUPOL sonusfit series

AVAILABLE

COLOURS

FOR FREE WEIGHTS TRAINING

REGUPOL everroll ultimate Available in standard or pre-sealed.

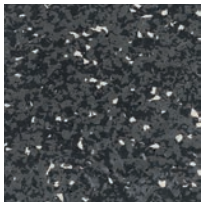

Mons [3138]
8mm (intensity mons)

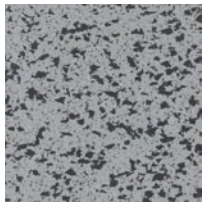

Island [3000]
8mm (intensity island)

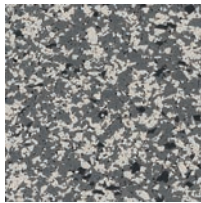

Paris [1085]
8mm (intensity berlin)

REGUPOL everroll classic Available in standard edition 4.0 or pre-sealed.

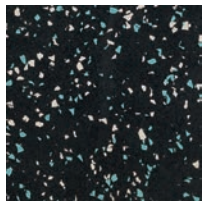

Auckland [3241]
8mm (tone auckland)

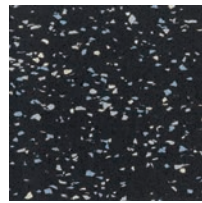

Nome [3121]
8mm (tone nome)

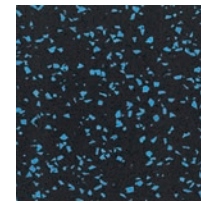

Palau [3031]
8mm (core palau)



Sydney [3240]
8mm (tone sydney)



Bern [3122]
8mm (tone berlin)

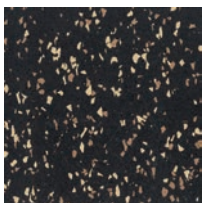

Kush [3118]
8mm (tone kush)

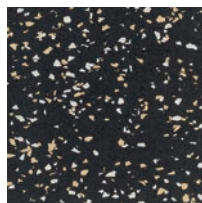

Lhasa [3180]
8mm (tone lhasa)



Amsterdam [3145]
8mm (core amsterdam)

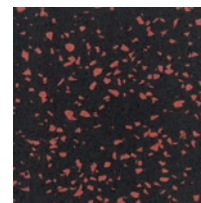

Goa [3033]
8mm (core goa)

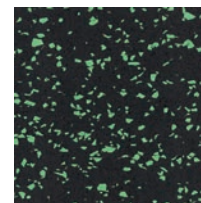

Manaus [3032]
8mm (core manaus)

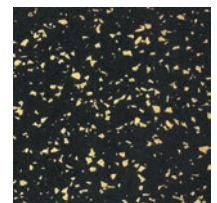

Melbourne [3029]
8mm (core melbourne)

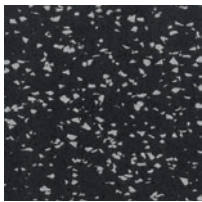

Berlin [3030]
8 | 12mm (core berlin)

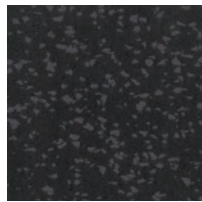

Mons [3256]
8 | 12mm (core mons)

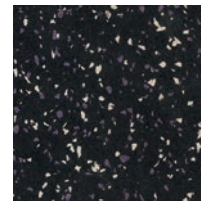

Perth [3239]
8mm (tone perth)

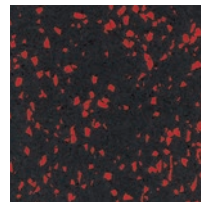

Marrakech [3276]
8mm (core marrakech)

edition 4.0 = brilliant colours and nonreflecting surface
(brackets show superceeded product name)



Deviations from the colours shown are possible due to production batches and brochure print.

FREE WEIGHT TRAINING AREAS

This system reflects a typical application with **REGUPOL everroll** floor coverings. For all other applications please contact the **REGUPOL** sports division. Please note that drawings are not to scale and are for illustration purposes only.

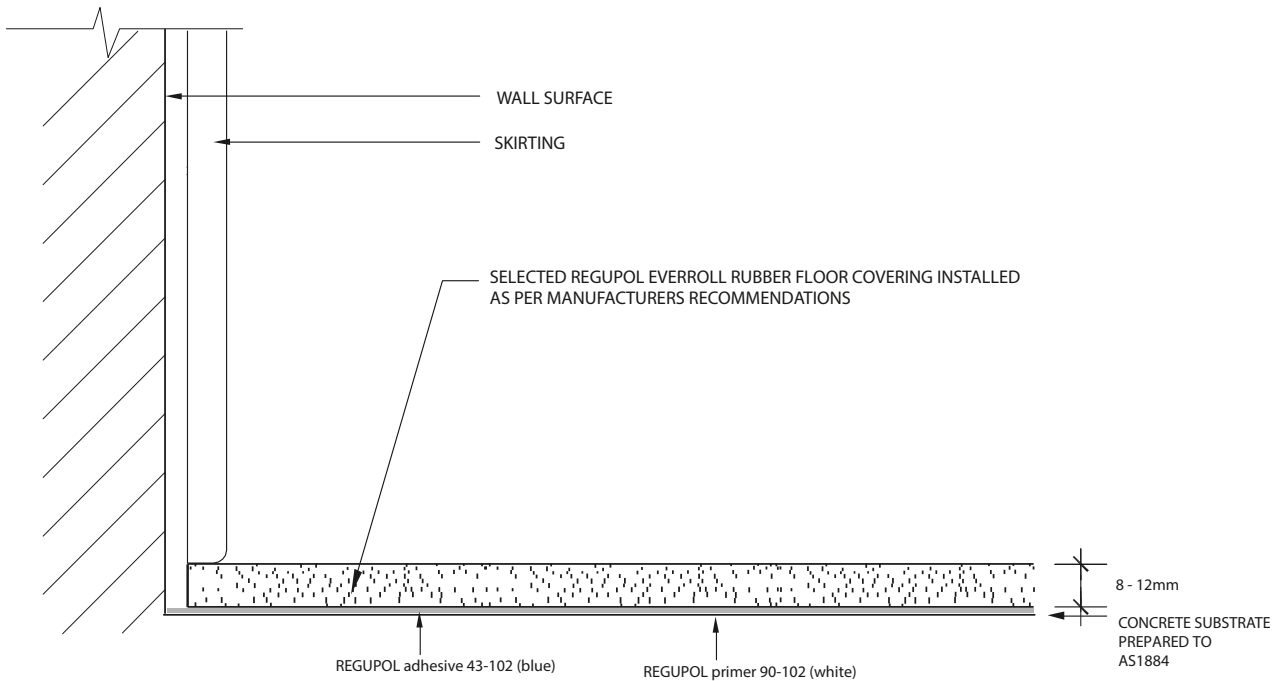
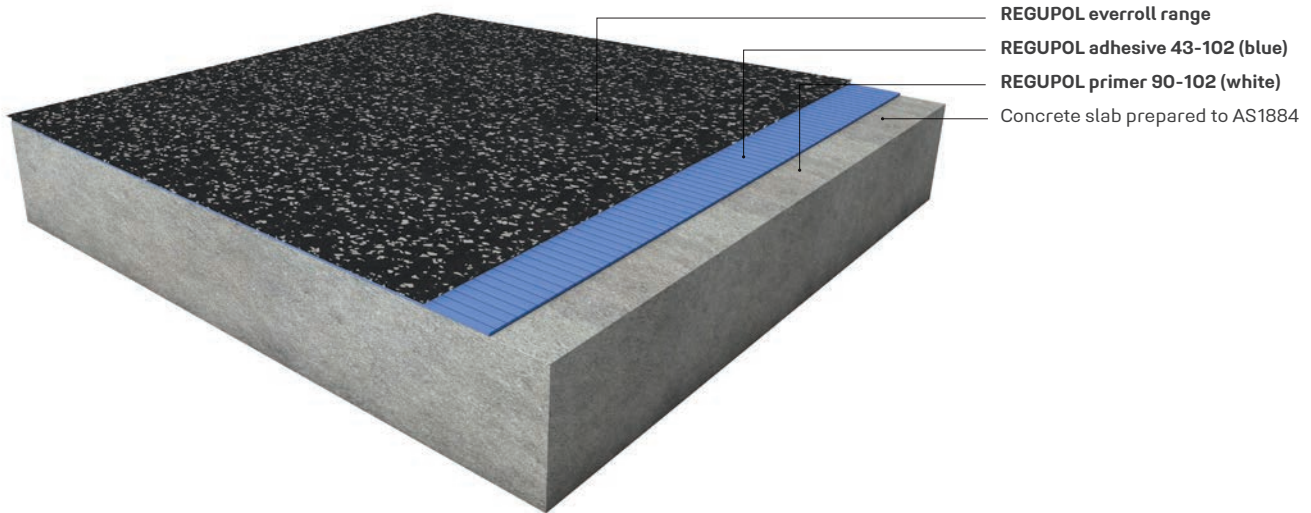

DISCLAIMER: The above information is given in good faith as a suggested guide in specifying REGUPOL everroll rubber flooring, no guarantee or warranty is expressed or implied. Any circumstances not covered by this guide should be referred to REGUPOL Australia or its Distributors for any particular attention required. There are, however, many factors that may affect the outcome of projects using our products that are beyond our control. REGUPOL Australia Pty. Ltd. cannot be responsible for poor climate conditions, inadequate surface preparation, poor application techniques, not observing curing times, improper thinning of adhesives or any variable beyond our control. No liability is accepted by REGUPOL Australia Pty. Ltd., our employees, distributors, representatives or agents, for any loss or damage, direct or indirect, that may result from using the information and/or suggestions as actual conditions for use that are beyond our control. All materials should be checked/tested for their suitability to the prevailing site conditions.

FREE WEIGHT TRAINING AREAS

This system reflects a typical application with **REGUPOL everroll impact** floor coverings. For all other applications please contact the **REGUPOL** sports division. Please note that drawings are not to scale and are for illustration purposes only.

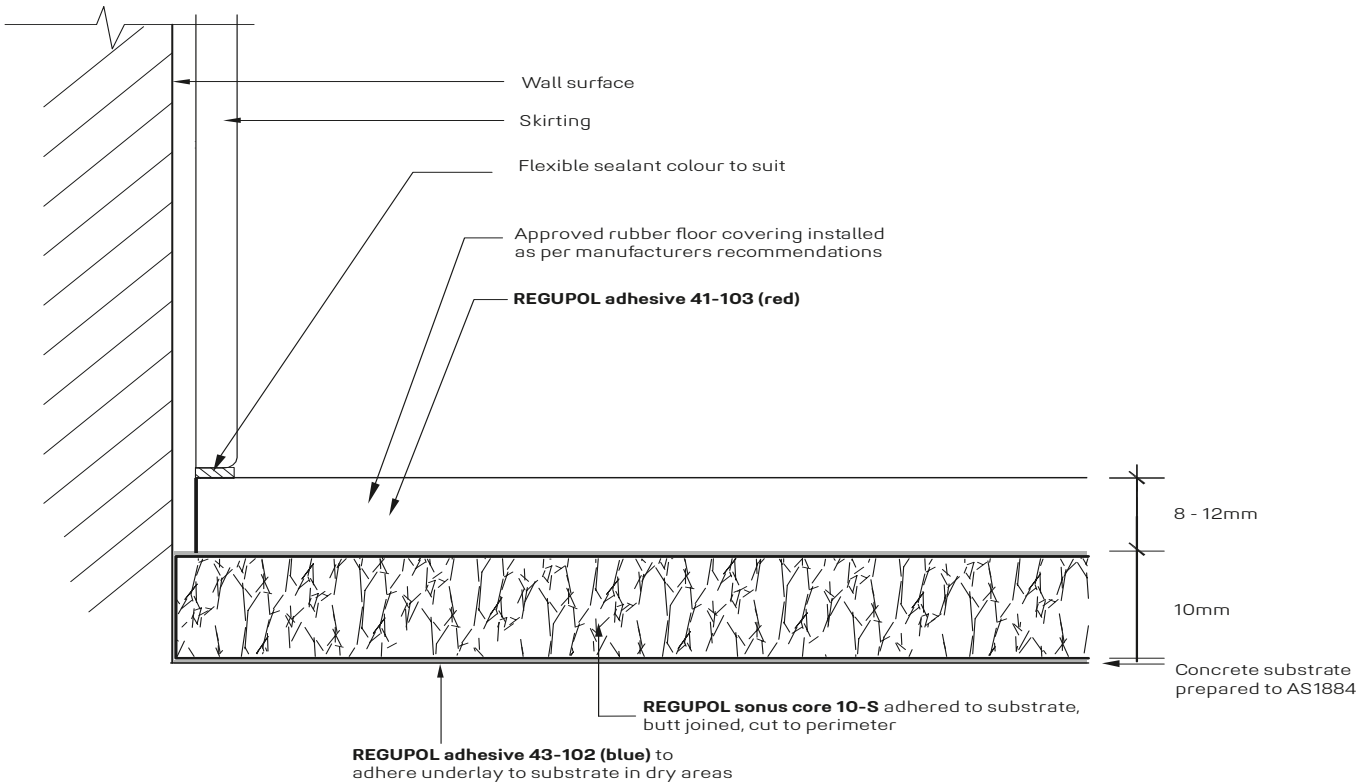
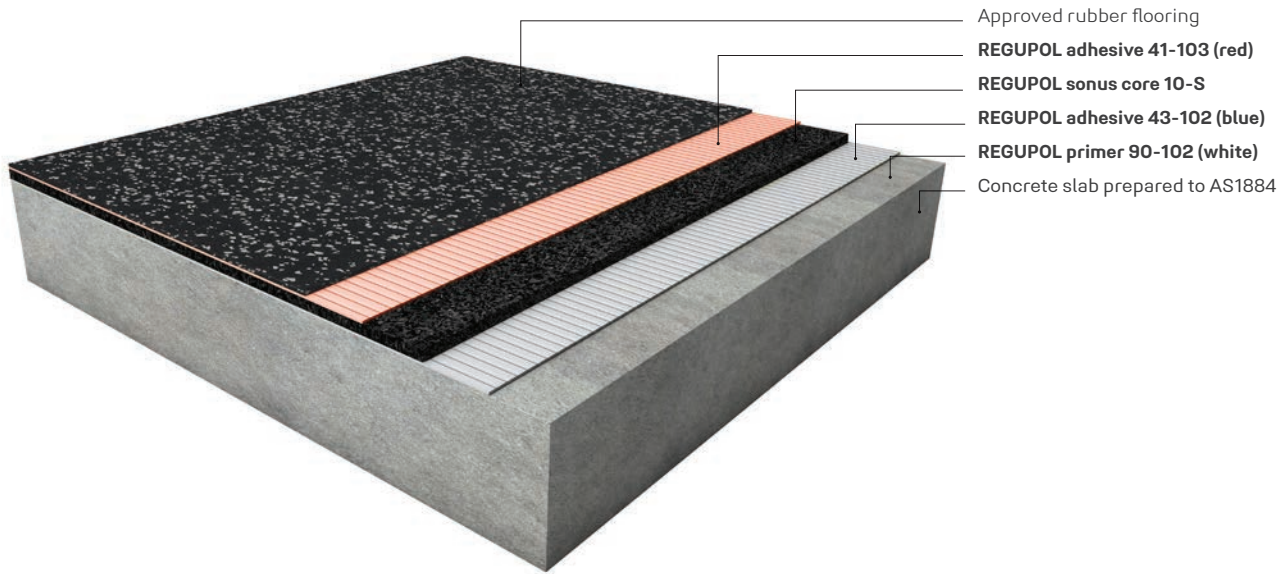

DISCLAIMER: The above information is given in good faith as a suggested guide in specifying REGUPOL everroll rubber flooring, no guarantee or warranty is expressed or implied. Any circumstances not covered by this guide should be referred to REGUPOL Australia or its Distributors for any particular attention required. There are, however, many factors that may affect the outcome of projects using our products that are beyond our control. REGUPOL Australia Pty. Ltd. cannot be responsible for poor climate conditions, inadequate surface preparation, poor application techniques, not observing curing times, improper thinning of adhesives or any variable beyond our control. No liability is accepted by REGUPOL Australia Pty. Ltd., our employees, distributors, representatives or agents, for any loss or damage, direct or indirect, that may result from using the information and/or suggestions as actual conditions for use that are beyond our control. All materials should be checked/tested for their suitability to the prevailing site conditions.



REGUPOL Australia Pty. Ltd.
155 Smeaton Grange Road
Smeaton Grange NSW 2567
phone +61 2 4624 0050
rubbersales@regupol.com.au

REGUPOL BSW GmbH
REGUPOL America LLC
REGUPOL Acoustics Middle East FZE
REGUPOL Schweiz AG
REGUPOL Zebra Athletics LLC
BSW Shanghai CO. LTD.

www.regupol.com



ANH NGOC THANH TRADING COMPANY LIMITED (ANTRADE CO., LTD.)

HCM office: R. 5.03, 5th Fl., Phuong Tower,
31C Ly Tu Trong Str., Ben Nghe W., Dist.1, HCMC.
Tel: (+84) 28 38257622 / 28 38257623

HN office: R. 701, 7th Fl., 131 Bui Thi Xuan Str.,
Hai Ba Trung District, Ha Noi City, Vietnam.
Tel: (+84) 24 63289487 / 24 39749263

Website: www.antrade.vn

Hotline: +84 933 662138

Email: sales@antrade.vn